

Pressure Test Ends

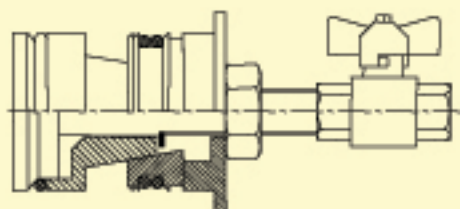







Pressure Test Ends

Pressure Test Ends are used for pressure testing pipe systems either before or after installation. They expand and grip in the same manner as an expanding towing head which means they are quick and simple to fit and also easily removed.

They have an expanding O ring which seals on the inside of the pipe.

Features –

-  SDR Specific Sizes from 40mm to 400mm.
-  Small bore, zinc plated steel for use in the Gas Industry.
-  Large Bore Stainless Steel for Water Industry.
-  Optional outer sleeve for high pressure testing.
-  The internal pressure acting on the base forces the teeth to grip harder as the pipe expands.
-  Tested to the bursting pressure of the pipe.

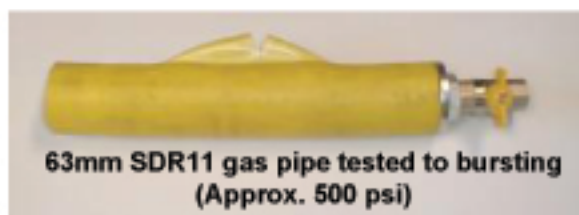

Under pressure, nothing better ...